

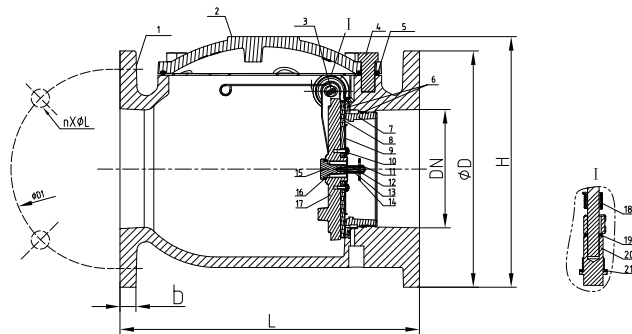

PRODUCT FEATURE

1. PRECISE DELAY DEVICE PREVENTS FALSE ALARMS. THE ALARM DELAY TIME OF THE DELAY DEVICE IS 5-90S. THERE IS A DRIP VALVE UNDER THE DELAY DEVICE, WHICH CAN DRAIN THE WATER IN THE DELAY DEVICE WITHIN 5MIN.
2. THE INTERNAL COMPENSATION DEVICE PREVENTS MALFUNCTION, AND THE INTERNAL COMPENSATION DEVICE BALANCES THE PRESSURE OF THE UPPER AND LOWER CHAMBERS IN TIME TO PREVENT THE VALVE FROM MALFUNCTIONING
3. FULL DIAMETER DESIGN, LOW HEAD LOSS.
4. THE VALVE DISC ASSEMBLY CAN BE ROTATED OUT OF THE BODY, AND THE SEALING GASKET CAN BE REPLACED ONLINE.



MATERIAL SPECIFICATION

Part No.	Part	Standard Specification
1	Valve Body	ASTM A536, 65-45-12
2	Bonnet	ASTM A536, 65-45-12
3	Pin	AISI 304
4	Hex Bolt	Carbon Steel Zinc Plated
5	Body Gasket	EPDM
6	O-Ring	NBR
7	Seat	C83600
8	Gasket	EPDM
9	Disc Gland	AISI 304
10	Slotted Screw	AISI 304
11	Hexagonal Nut	AISI 304
12	Adjusting Screw	AISI 304
13	Core Tube	AISI 304
14	Core Board	AISI 304
15	Disc Core	C89833
16	O-Ring	NBR
17	Disc	C83600
18	Spring	AISI 304
19	Sealing Fillet Gasket	PTFE
20	Sealing Plug	AISI 304
21	Sealing Fillet Gasket	PTFE

Note: For special material request other than standard specification, please indicate clearly on the inquiry or order list.



ALARM CHECK VALVE GMC-ACV-GG

GLOBE MECHANICAL CONTROL LLC.

DN		Dimensions(mm)					
Inch	mm	H	L	D	DI	b	n-φL
3"	80	235	241	191	152.4	19	4-φ 19.1
4"	100	241	292	229	190.5	24	8-φ 19.1
6"	150	298	356	279	241.3	25.5	8-φ 22.2
8"	200	352	495	343	298.5	28.5	8-φ 22.2

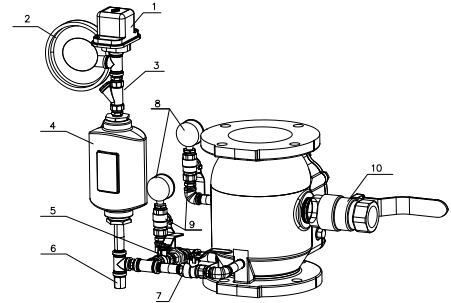
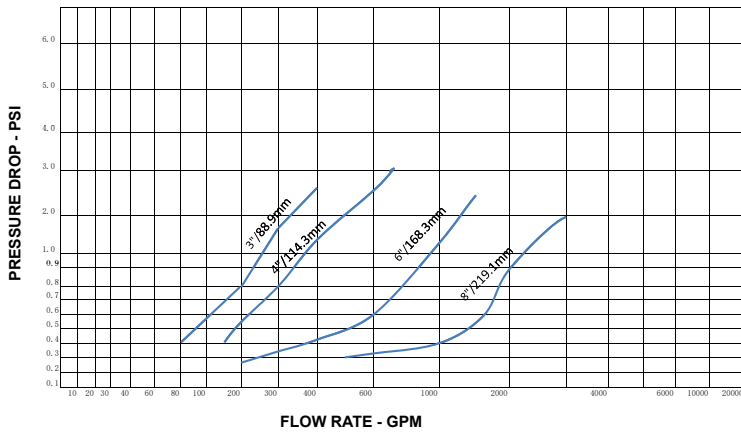

Outside Part			
Part No.	Part	Part No.	Part
1	Pressure Switch	6	Drip Valve
2	Alarm	7	Alarm Ball Valve
3	Strainer	8	Pressure Gauge
4	Retard Chamber	9	Pressure Gauge Ball Valve
5	Test Ball Valve	10	Drain Ball Valve

Weight – lb. (kg)

SIZE	D80	D100	D150
Weight	17.8828	27.3649	36.796

NAMEPLATE

