

PRODUCT FEATURE

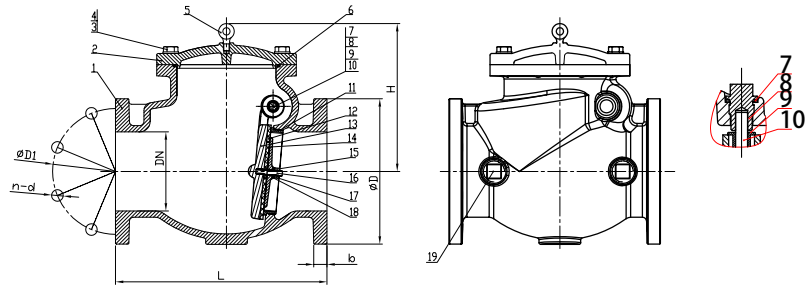

THE PRODUCT DESIGN COMPLIES WITH AWWA C508 AND HAS PASSED UL/FM CERTIFICATION. THIS CHECK VALVE ADOPTS HIGH-QUALITY MATERIALS AND STRICT PRODUCTION PROCESSES, WHICH HAVE HIGH RELIABILITY AND SERVICE LIFE. MEANWHILE, ITS REASONABLE STRUCTURAL DESIGN ALSO MAKES THE VALVE EASY TO MAINTAIN AND REPLACE.

1. ALL CASTINGS ARE MADE OF DUCTILE IRON MATERIAL, WITH A SPHEROIDIZATION RATE REACHING THE INTERNATIONAL LEVEL TWO, HIGH STRENGTH, AND GOOD CORROSION RESISTANCE.
2. THE VALVE BODY IS LIGHT, THE VALVE DISC HAS A SHORT OPENING AND CLOSING STROKE, A STREAMLINED STRUCTURE, AND LOW FLOW RESISTANCE.
3. SHORT CLOSING TIME, ABLE TO ACHIEVE QUICK CLOSING FUNCTION, WITH GOOD ENERGY-SAVING EFFECT.
4. AKZONOBEL NON-TOXIC ANTI-CORROSION COATING: THE INNER AND OUTER SURFACES OF THE VALVE ARE COATED WITH NON-TOXIC EPOXY RESIN POWDER ELECTROSTATIC COATING, WHICH IS UNIFORM, HAS STRONG ADHESION, ANTI-CORROSION, AND LONG SERVICE LIFE. IT MEETS THE ANSI/AWWA C550 STANDARD AND CAN BE DIRECTLY USED IN THE DRINKING WATER, FOOD AND PHARMACEUTICAL INDUSTRIES.



MATERIAL SPECIFICATION

Part No.	Part	Standard Specification
1	Body	Ductile Iron 65-45-12
2	Bonnet	Ductile Iron 65-45-12
3	Bolts	Carbon Stell Zine Plated
4	Washer	Carbon Stell Zine Plated
5	Eye Bolt	Carbon Stell Zine Plated
6	O-Ring	NBR
7	Washer	PTFE
8	Plug	AISI 304
9	Hinpe	AISI 420
10	Seat Ring	Bronze ASTM B62
11	Seal	EPDM
12	Disc	Ductile Iron 65-45-12
13	Plate	Ductile Iron 65-45-12(6"-12") AISI 304(2"-4")
14	Nut	AISI 304
15	Bolt	AISI 304
16	Spring Washer	AISI 304
17	Flat Washer	AISI 304
18	Plug	Tin bronze

Note: For special material request other than standard specification, please indicate clearly on the inquiry or order list.



SWING CHECK VALVE GMC-SCV-FF
GLOBE MECHANICAL CONTROL LLC.

DN		Dimensions(mm)						
Inch	mm	L		D	D1	b	n-Φd	H
		Standard	Optional					
2"	50	203	203	152	120.5	16	4-Φ19.1	133
2.5"	65	254	216	178	139.5	17.5	4-Φ19.1	150
3"	80	278	241	191	152.5	19	4-Φ19.1	150
4"	100	330	292	229	190.5	24	8-Φ19.1	218
6"	150	406	356	279	241.5	25.5	8-Φ22.2	290
8"	200	495	495	343	298.5	28.5	8-Φ22.2	330
10"	250	622	622	406	362	30.5	12-Φ25.4	350
12"	300	660	698	483	432	32	12-Φ25.4	376

Note: Standard of Face-to-Face in according with AWWA C508.
 Optional of Face-to-Face in according with ASME B16.10 CL125.

Weight – lb. (kg)

SIZE	D65	D80	D100	D150	D200	D250
Weight	27.5 (12.5)	36.4 (16.5)	55.8 (25.3)	105.8 (48.0)	192.9 (87.5)	292.2 (132.5)

NAMEPLATE

